

(2 required; left = right)

cut as shown

V for weld

bend end faces

weld

trim, grind

smooth

weld mounting tabs (2)

smooth as required

buff, chrome

RABUGGI

Front Bumperette Cutting Plan

10-31-14 R.A.B.

rev. 11-15-14 R.A.B.

scale = 1/2

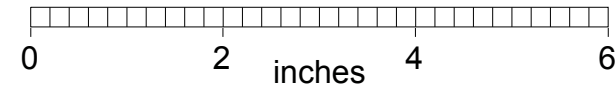

3 x 2 x 11 ga. (.120)
A513 rectangular steel tube

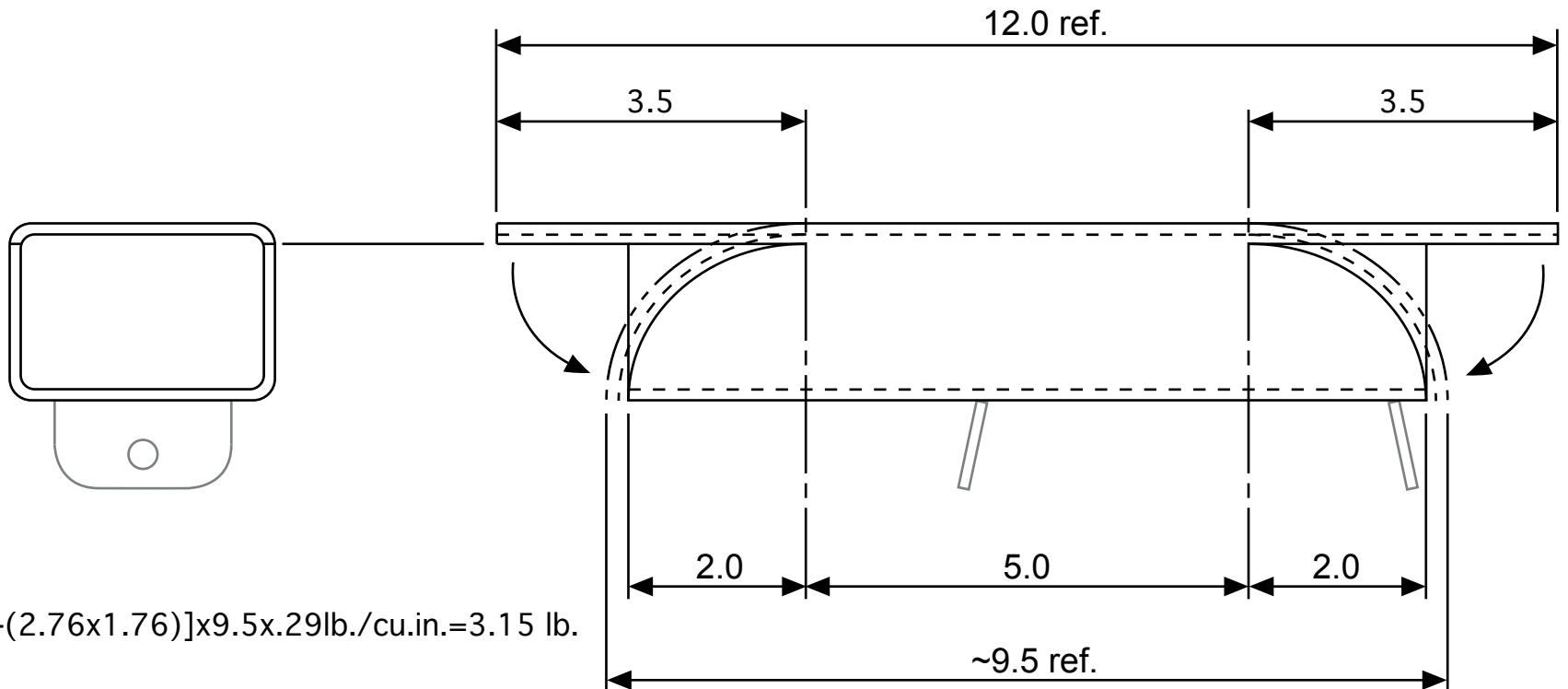

$[(3 \times 2) - (2.76 \times 1.76)] \times 9.5 \times .29 \text{ lb./cu.in.} = 3.15 \text{ lb.}$